

Hockley, Essex, SS5



£289,000



This brand new, modern-furnished Pathfinder luxury park home (37x19) is perfect for those looking for a detached, easy to maintain, bungalow style retirement property. The home features a spacious kitchen and a separate living/dining area, two bedrooms and two bathrooms.

The park is situated in on the banks of the River Crouch and is well suited if you have a love of sailing and fishing, with four yacht clubs and a first class course within easy reach. Buses stop nearby going to Southend, Chelmsford and Basildon, all excellent shopping and entertainment centres. The nearest railway station is at Rayleigh four miles away with trains to London Liverpool Street taking about forty minutes. Hullbridge has good shopping facilities including a library, post office and doctors' surgery.

Age restriction: Over 50's
 Pet friendly: Yes
 Site fees: £276 per month
 Residential license

Key Features

- Brand new home
- Coming soon
- Community living
- Established park
- Fully furnished
- Over 50's
- Part exchange available
- Pet-friendly
- Residential park home
- Shops and amenities nearby

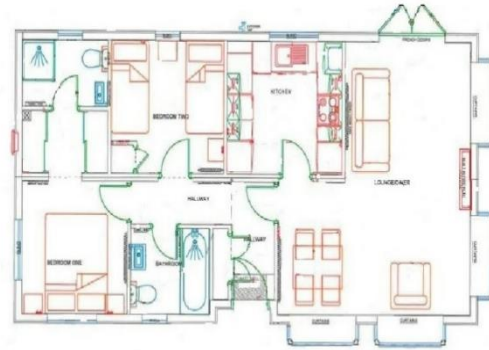

House to sell?

Hassle-free Property Part-Exchange is available from Quickmove Properties, with no estate agent fees, no solicitor's fees and no market uncertainty.

CONTACT US

01793 840917

advice@quickmoveproperties.co.uk

