

Bordon, Hampshire, GU35



Price as listed



This pre-owned, modern luxury (42'x14') park home is perfect for those looking for a detached, easy-to-maintain, bungalow-style property. The home features an open plan kitchen, living and dining area with large windows. There are two bedrooms and a family bathroom. The landscaped exterior features a generous garden with a shed and driveway.

This park is a large, established residential development backing onto countryside. This development is located on the edge of Bordon, a Hampshire town surrounded by forests, countryside and nature reserves. Nearby amenities in Bordon include supermarkets Tesco and Lidl, pubs and shops and golf clubs. The development is half an hour's drive from Portsmouth and 50 minutes from Southampton. The nearest train stations are in the neighbouring towns of Liphook and Alton.

Age restriction: Over 45s

Pet friendly: Yes

Site fees: £276.40 per month

Residential license

Key Features

- Driveway
- Garden space
- Modern design
- Over 45s
- Part Exchange Available
- Pet-Friendly
- Pre-owned park home
- Residential Development
- Two Bedrooms
- Well maintained home

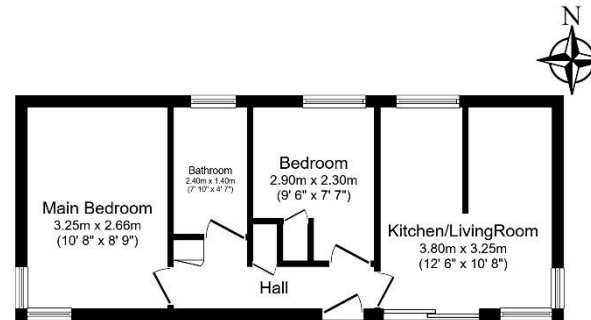

Total floor area 37.7 sq.m. (405 sq.ft.) approx

This floor plan is for illustrative purposes only. It is not drawn to scale. Any measurements, floor areas (including any total floor area), openings and orientation are approximate. No details are guaranteed, they cannot be relied upon for any purpose and they do not form part of any agreement. No liability is taken for any error, omission or misstatement. A party must rely upon its own inspection(s). Powered by www.foolsgeni.com

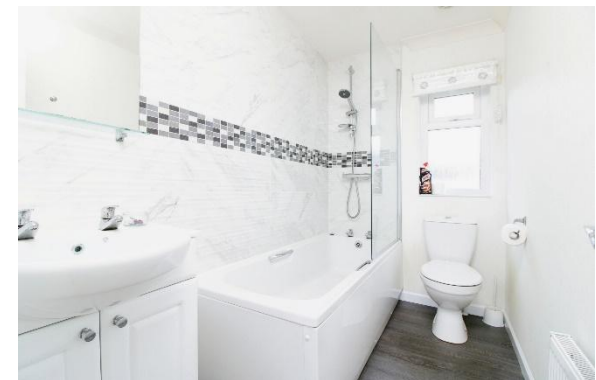

House to sell?
 Hassle-free Property Part-Exchange is available from Quickmove Properties, with no estate agent fees, no solicitor's fees and no market uncertainty.

CONTACT US

01793 840917

advice@quickmoveproperties.co.uk

