

Bovey Tracey, Devon, TQ13



Price as listed



This brand new, fully furnished modern Manor Berkeley Plus (45'x14') park home boasts the latest construction techniques, design, and modern full furnishings. The home has a spacious kitchen, living and dining area, two bedrooms and two bathrooms.

This residential development is conveniently situated on the outskirts of Bovey Tracey, a typical small Devon town with good shopping facilities. The Park features mature woodland, a large lake and views of the rolling hills of Dartmoor. A bus service to Newton Abbot stops at the Park entrance and a mobile library calls fortnightly.

There are many places of interest to explore, such as Torbay, the cathedral City of Exeter and of course the beauty of Dartmoor which is only a 10-minute drive away. All the new homes sited are fully furnished and have tiled roofs, mains gas central heating and double glazing.

Age restriction: Over 50's
 Pet friendly: Yes (one per home)
 Site fees: £273 per month
 Stock images have been used, the home on site may vary

House to sell?
 Hassle-free Property Part-Exchange is available from Quickmove Properties, with no estate agent fees, no solicitor's fees and no market uncertainty.

Key Features

- Brand New Design
- Brand new home
- Community Living
- Exceptionally High Specification
- Fully Furnished
- Outstanding Location
- Over 50s
- Part Exchange Available
- Pet-Friendly
- Residential Development

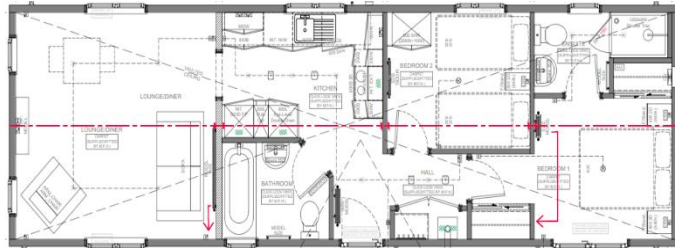

CONTACT US
 01793 840917
advice@quickmoveproperties.co.uk

