

# Bury St. Edmunds, Suffolk, IP31

**Quickmove**  
PROPERTIES



£230,000

 x 2

 x 2

This brand new, modern-furnished Pathfinder luxury park home is perfect for those looking for a detached, easy to maintain, bungalow style retirement property. The home features a spacious kitchen and a separate living/dining area, two bedrooms and two bathrooms. The lounge features a fireplace, TV point and French doors, the fitted kitchen includes a built in oven, hob and integrated appliances.

The historic market town of Bury St. Edmunds is famous for its Cathedral, Abbey Ruins and Floral Gardens. Whilst steeped in history, it has a modern shopping centre, theatre, sports and leisure activities. Shepherds Grove is uniquely situated to enjoy the glories of the East Anglian scene, including Constable country, the Norfolk Broads and the local heathlands.

Age restriction: Over 50s

Pet friendly: Yes (2 per home)

Site fees: £230 per month

Residential license

### Key Features

- Brand new home
- Coming soon
- Community Living
- Established Park
- Fully Furnished
- Over 50s
- Part Exchange Available
- Pet-Friendly
- Residential Park Home
- Shops and amenities nearby

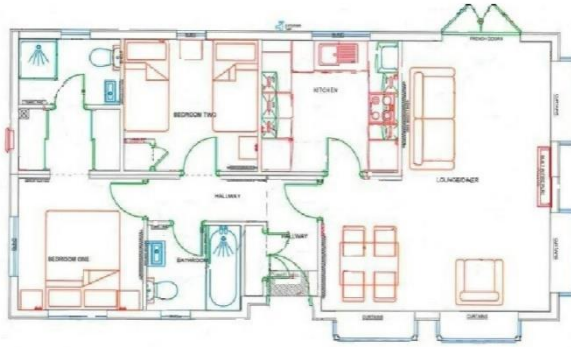

### House to sell?

Hassle-free Property Part-Exchange is available from Quickmove Properties, with no estate agent fees, no solicitor's fees and no market uncertainty.

### CONTACT US

01793 840917

[advice@quickmoveproperties.co.uk](mailto:advice@quickmoveproperties.co.uk)

**Quickmove**  
PROPERTIES

