

Christchurch, Dorset, BH23



£250,000



This brand new, modern-furnished Prestige Majestic luxury park bungalow (40'x20') is perfect for those looking for a detached, easy to maintain, bungalow-style retirement property. The interior design is warm and inviting with a comfortable sofa and an open plan kitchen/dining room and separate living room. The home has two double bedrooms and two bathrooms.

This development offers easy access to the neighbouring towns of Bournemouth and Poole, as well as surrounding country parks including the New Forest and Moors Valley Country Park which offer wonderful walking trails. Enjoy markets, great local food outlets, proximity to the beach, forest, and Bournemouth Airport, in a highly sought-after rural location in Dorset.

Age restriction: Over 45s

Pet friendly: Yes (2 per home)

Site fees: £283.16 per month

Residential license

Stock images have been used, the home on site may vary.

Key Features

- Brand new home
- Community Living
- Countryside location
- Fully Furnished
- Integrated Appliances
- Part Exchange Available
- Pets welcome
- Residential development
- Over 45s
- Two bedrooms

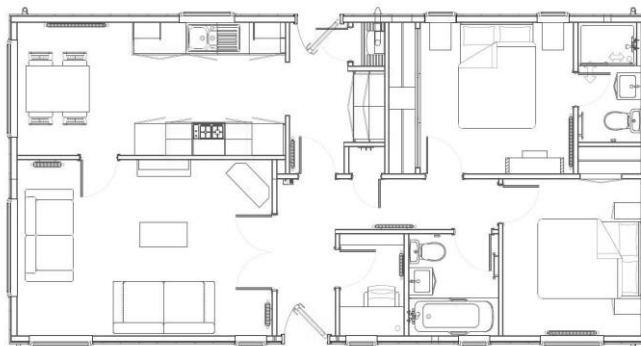

House to sell?

Hassle-free Property Part-Exchange is available from Quickmove Properties, with no estate agent fees, no solicitor's fees and no market uncertainty.

CONTACT US

01793 840917

advice@quickmoveproperties.co.uk

