

Borehamwood, Hertfordshire, WD6

Quickmove  
PROPERTIES



£229,000

🛏 x 2

🛁 x 1

This brand new, modern-furnished Harbur H4 luxury park home (34'x14') is perfect for those looking for a detached, easy to maintain, bungalow-style property. The home features an integrated kitchen, comfortable living area, one bedroom and a bathroom

Exclusive for the over 50s, this welcoming park is situated on the edge of Borehamwood. Buses stop outside the park going to Borehamwood, Barnet, Edgware and Burnt Oak.

Just 12 miles from Marble Arch, and 3 miles from Barnet. As well as the bus routes from the park entrance there are also tube stations at Barnet and Edgware. There are good local sporting facilities including golf and swimming.

Age restriction: Over 50s

Pet friendly: Yes

Site fees: £280 per month

Residential license

### Key Features

- Brand new home
- Bus Stop Nearby
- Cat Friendly
- Community Living
- Fully Fitted Kitchen

- Fully Furnished
- Integrated Appliances
- Over 50s
- Part Exchange Available
- Residential Park

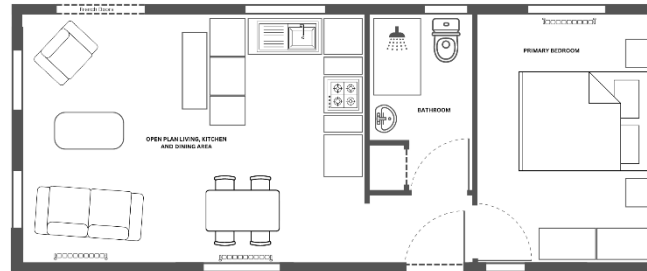

### House to sell?

Hassle-free Property Part-Exchange is available from Quickmove Properties, with no estate agent fees, no solicitor's fees and no market uncertainty.

### CONTACT US

01793 840917

[advice@quickmoveproperties.co.uk](mailto:advice@quickmoveproperties.co.uk)

**Quickmove**  
PROPERTIES

