

Great Yarmouth, Norfolk, NR31



£145,000



This pre-owned, refurbished park home is perfect for those looking for a detached, easy-to-maintain, bungalow-style property. The home has been refurbished, it has a good-sized kitchen with integrated appliances, comfortable living room, two double bedrooms and a bathroom. The landscaped exterior boasts brand new decking, an easy to maintain garden and driveway.

This development is located on the edge of Great Yarmouth. The coastal town has a fantastic pier, beach, restaurants, amusements and Sea Life Centre. The Norfolk Broads National Park is just 13 miles away, where you can enjoy stunning scenery and walking routes.

Age restriction: Over 50s

Pet friendly: Yes

Site fees: £280 per month; includes water and sewerage

Residential license

Key Features

- Coastal Location
- Decking
- Garden space
- Over 50s
- Parking space
- Part Exchange Available
- Pet-Friendly
- Pre-owned park home
- Residential Development
- Two Bedrooms

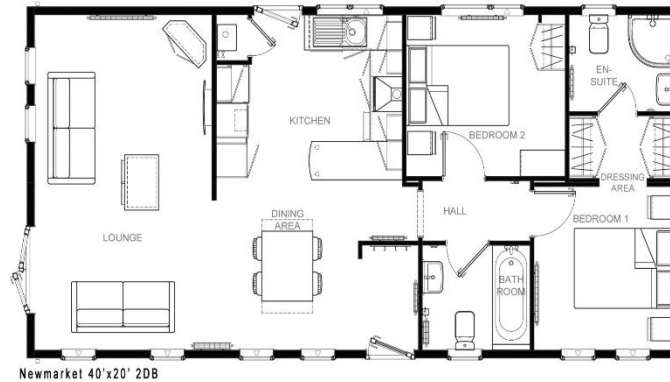

House to sell?

Hassle-free Property Part-Exchange is available from Quickmove Properties, with no estate agent fees, no solicitor's fees and no market uncertainty.

CONTACT US

01793 840917

advice@quickmoveproperties.co.uk

