

Ferndown, Dorset, BH22



£156,500



This pre-owned (28'x19') park home is perfect for those looking for a detached, bungalow-style property. The home has a kitchen, living room with an electric fireplace and patio door, two bedrooms and a bathroom with a walk in shower. The exterior feature a parking space and a garden area.

This development is a short drive away from the beauty of the New Forest with its quaint villages and famous ponies. Ferndown is just a mile away where there are local shops, doctors, dentist and a library, etc. There are bus services to Poole, Wimborne, Bournemouth (famous for its shopping centre, theatres and beaches) and Southampton. For those who play, a golf course is within walking distance of the park.

Age restriction: Over 50s

Site fees: £182.33 per month

Residential license

Key Features

- Community Living
- Garden space
- Over 50s
- Part Exchange Available
- Pre-owned park home
- Residential Park
- Shops and amenities nearby
- Two Bedrooms

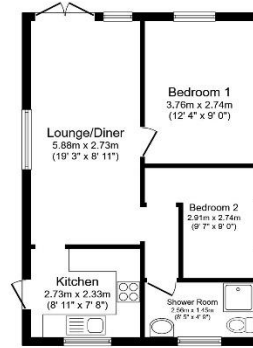

Total floor area 46.3 m² (498 sq.ft.) approx

This floor plan is for illustrative purposes only. It is not drawn to scale. Any measurements, floor areas (including any total floor area), openings and orientation are approximate. No details are guaranteed, they cannot be relied upon for any purpose and they do not form part of any agreement. No liability is taken for any error, omission or misstatement. A party must rely upon its own inspection(s). Powered by www.housespart.com



House to sell?

Hassle-free Property Part-Exchange is available from Quickmove Properties, with no estate agent fees, no solicitor's fees and no market uncertainty.

CONTACT US

01793 840917

advice@quickmoveproperties.co.uk

