

# Hereford, Herefordshire HR2



£218,000



This brand new, modern-furnished luxury park home is perfect for those looking for a detached, easy to maintain, bungalow-style property. The home features a modern, spacious kitchen and dining room with integrated appliances, leading to a comfortable living room. There are two double bedrooms, an en suite shower room and a family bathroom with another shower and toilet. The exterior has a driveway and wonderful countryside views.

The park is ideally located for offering the peace of the countryside whilst still being close to amenities. Hereford town centre is just 2 miles away and there is a bus stop directly at the park entrance to the centre of town. Wye Valley, an Area of Outstanding Natural Beauty is just 6 miles away, where you can find walking routes and nature trails. The Malvern Hills is a further 20-minute drive offering beautiful countryside and walks.

Site fees: £180 per month

Pet Friendly: Yes

Age restrictions: Over 45's

Residential license

### House to sell?

Hassle-free Property Part-Exchange is available from Quickmove Properties, with no estate agent fees, no solicitor's fees and no market uncertainty.

### Key Features

- Brand new home
- Bus stop at park entrance
- Countryside Views
- Dog friendly
- Fully Furnished
- Part Exchange Available
- Residential Development
- Shops and amenities nearby
- Small exclusive development
- Two Double Bedrooms

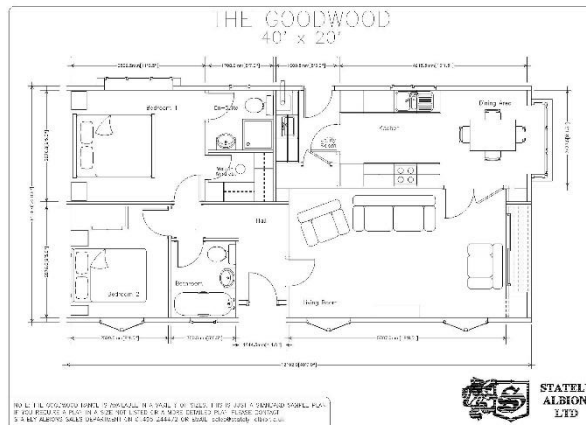

## CONTACT US

01793 840917

advice@quickmoveproperties.co.uk

**Quickmove**  
PROPERTIES

