

Biggleswade, Bedfordshire, SG18

Quickmove
PROPERTIES



£199,995

 x 2

 x 2

This brand new, modern-furnished Willerby Kingswood (40'x20') luxury park home is perfect for those looking for a detached, easy-to-maintain, bungalow-style property. The home has a modern kitchen with integrated appliances, a comfortable living area, two bedrooms and two bathrooms.

Located on the edge of Biggleswade in Bedfordshire the park is just a mile from the local village and walking distance from the nearest bus stop, with a local store close by. The area has a large selection of indoor and outdoor activities. From the Bedford Corn Exchange, the R.S.P.B, Lodge Nature Reserve in Sandy and the Willington Dovecote and Stables, and the general market that is held in the market square each Saturday.

Age restriction: Over 50s

Pet friendly: Yes

Site fees (at time of listing): £246.13

Residential license

Key Features

- Brand new home
- Bus Stop Nearby
- Community Living
- Countryside location
- Fully Furnished
- Small exclusive development
- Over 50s
- Part Exchange Available
- Residential Development
- Two Double Bedrooms

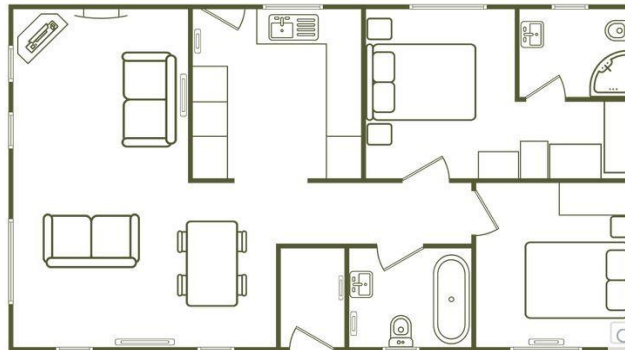

House to sell?

Hassle-free Property Part-Exchange is available from Quickmove Properties, with no estate agent fees, no solicitor's fees and no market uncertainty.

CONTACT US

01793 840917

advice@quickmoveproperties.co.uk

