

Tewkesbury, Gloucestershire, GL20



£90,000



This brand new, modern-furnished Victory Bower (40'x12') luxury lodge is perfect for those looking for a detached, easy to maintain, bungalow-style lodge. The lodge is fully furnished, it features a spacious kitchen, dining area, and living room, two bedrooms and two bathrooms.

This holiday home comes with a 15-year lease, allowing long-term use of the site. Additionally, it operates under a 10-month holiday license.

This picturesque development is located down a country lane on the outskirts on Twyning in Gloucestershire, alongside the River Avon. Cheltenham, Worcester and Gloucester are within easy reach, providing plenty of amenities. The nearby village of Twyning offers the nearest amenities including a village shop and post office.

Age restriction: None

Pet friendly: Yes

Site fees (at time of listing): £4,000 per year

Leisure license

Key Features

- 10 month leisure license
- Brand new home
- Countryside location
- Decking
- Fully Furnished
- House buying service
- No age restriction
- Pet-Friendly
- Stunning views
- Two Bedrooms

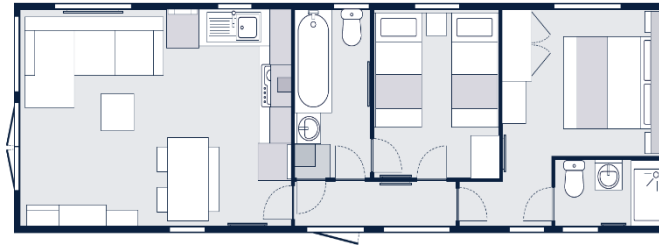

House to sell?

Hassle-free Property Part-Exchange is available from Quickmove Properties, with no estate agent fees, no solicitor's fees and no market uncertainty.

CONTACT US

01793 840917

advice@quickmoveproperties.co.uk

Quickmove
PROPERTIES

