

# Stoke-On-Trent, Staffordshire, ST10



Price as listed



This brand-new, modern-furnished ABI Beverley (39'x12') luxury lodge is perfect for those looking for a detached, easy-to-maintain, bungalow-style property. The lodge has a modern kitchen with integrated appliances, a comfortable living room, two bedrooms and a shower room. The lodge also has parking for two cars.

This brand new 12 month leisure development is set between the Derbyshire Dales and the Staffordshire countryside. The development is located 8 miles from Ashbourne, a popular tourist town known to the Derbyshire Dales. Ashbourne has the nearest Medical Centre and many boutique shops, restaurants and traditional pubs. 11 miles from the park is Stoke-on-Trent, which has all large city amenities including supermarket chains.

Age restriction: None

Pet Friendly

Site fees: £4,000 per year

Leisure license

Stock images have been used.

### House to sell?

Hassle-free Property Part-Exchange is available from Quickmove Properties, with no estate agent fees, no solicitor's fees and no market uncertainty.

### Key Features

- 12 Month Leisure Licence
- Brand new home
- Exceptionally High Specification
- Fully Furnished
- No age restriction
- Parking for two cars
- Pet-Friendly
- Two Bedrooms
- Modern home
- Two bedrooms

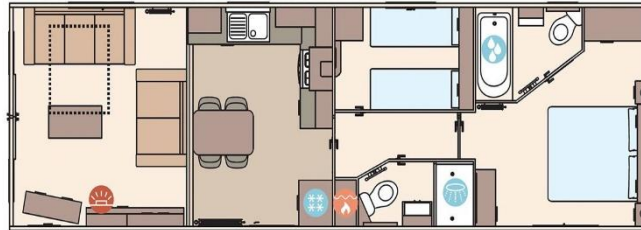

39FT X 12FT X 2 BEDROOM



## CONTACT US

01793 840917

advice@quickmoveproperties.co.uk

