

# Weymouth, Dorset, DT3



Price as listed



This brand-new, modern-furnished Willerby Kingswood (40'x20') luxury park home is perfect for those looking for a detached, easy-to-maintain, bungalow-style property. The homes has a spacious, modern kitchen with integrated appliances, a comfortable living room, two double bedrooms and two bathrooms.

This park offers seaside living at its best! Just a short stroll away is the spectacular Dorset coastal path, which forms part of the 95 mile Jurassic Coast. Nearby is the popular Georgian town of Weymouth where you will find all major supermarkets, your favourite high street brands, a wide range of tourist attractions.

Age restriction: Over 45s

Pet friendly

Site fees: £269.12 per month

Residential license

Stock images have been used, the home may vary

### Key Features

- Brand new home
- Coastal Location
- Community Living
- Fully Furnished
- Modern design
- Over 45s
- Part Exchange Available
- Pet-Friendly
- Town location
- Two Bedrooms

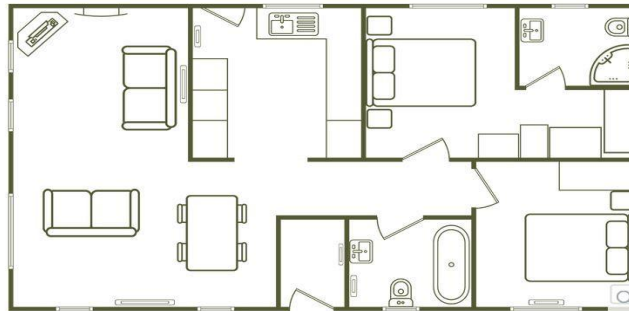

### House to sell?

Hassle-free Property Part-Exchange is available from Quickmove Properties, with no estate agent fees, no solicitor's fees and no market uncertainty.

### CONTACT US

01793 840917

[advice@quickmoveproperties.co.uk](mailto:advice@quickmoveproperties.co.uk)

