

Swansea, Wales, SA5



Price as listed



This brand-new, modern-furnished Willerby Kingswood (40'x20') luxury park home is perfect for those looking for a detached, easy-to-maintain, bungalow-style property. The home has a modern kitchen with integrated appliances, a dining area and a comfortable living room. There are two double bedrooms, an en suite and a main bathroom.

This development is extremely popular due to its excellent location and established friendly community. This development has excellent road links take you to a multitude of areas of outstanding scenery, whether your preference is rolling countryside or spectacular coastal views.

Age restriction: Over 50s

Pet friendly: Yes

Site fees: £204.03 per month

Residential license

Stock images have been used, the home on site may vary.

Key Features

- Brand new home
- Community Living
- Exceptionally High Specification
- Fully Furnished
- Over 50s
- Part Exchange Available
- Residential Development

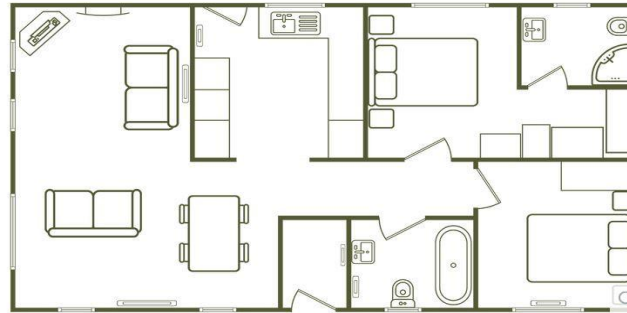

House to sell?

Hassle-free Property Part-Exchange is available from Quickmove Properties, with no estate agent fees, no solicitor's fees and no market uncertainty.

CONTACT US

01793 840917

advice@quickmoveproperties.co.uk

Quickmove
PROPERTIES

