

Cottenham, Cambridgeshire, CB24

Quickmove
PROPERTIES



£105,000



This well-maintained pre-owned Glastonbury (40'x20') park home is perfect for those looking for a detached, easy-to-maintain, bungalow-style property. The home features a galley-style kitchen and utility room, dining area, living room with a fireplace, a master bedroom with an en suite and dressing area, and a second bedroom and bathroom. The home has one dedicated parking spot directly opposite and a rear patio garden.

This park is an established family run residential home park that has been in the same ownership since 1968 and is situated off the High Street in Cottenham Village. The park offers a quiet tranquil setting with open areas and walks around a private lake with abundant wildlife. Cottenham is a large and prosperous village with a wide variety of shops and facilities.

Age restriction: Over 55s

Site fees (at time of listing): £232 per month

Residential license

House to sell?

Hassle-free Property Part-Exchange is available from Quickmove Properties, with no estate agent fees, no solicitor's fees and no market uncertainty.

Key Features

- Close to public transport
- Community Living
- Established Park
- Family Owned Park
- Garden Shed
- Garden space
- Over 55's
- Pre-owned park home
- Shops and amenities nearby
- Two Bedrooms

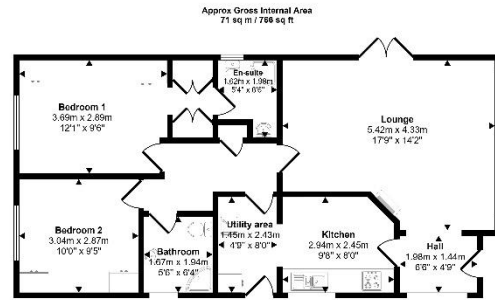

Floorplan

Whilst every attempt has been made to ensure the accuracy of the floor plan contained here, measurements of doors, windows, rooms and any other items are approximate and no responsibility is taken for any error, omission, or mis-statement. The measurements should not be relied upon for valuation, transaction and/or funding purposes. The plan is for illustrative purposes only and should be used as such by any prospective purchaser or tenant.



CONTACT US

01793 840917

advice@quickmoveproperties.co.uk

